

OSBORNE

Hog Feeders

U.S. Patent No. 4,353,329, 4,462,338 & 6,199,511
Patented Canada 1984. Others worldwide



RN1 SERIES

NURSERY CONFINEMENT FEEDER

Assembly & Operating Instructions

RLX-0526_D

Your Osborne Big Wheel hog feeders are packaged carefully and compactly to ensure their safe arrival at minimum cost. Each part was quality inspected prior to shipment and each carton was carefully packed to ensure that all necessary parts were present for the assembly.

UNPACKING

Upon receiving your shipment, check the cartons for handling damage in transit. ALERT THE DELIVERING CARRIER IMMEDIATELY if damage is discovered. Continue unpacking only after the carrier has acknowledged the damage and potential loss of contents.

NOTICE

All loss or damage in transit is the responsibility of the delivering carrier, NOT OSBORNE INDUSTRIES. To protect your rights in the event of damage or loss, **sign the delivery waybill only after the carrier has acknowledged in writing that damage or loss has occurred.** In the event that damage is revealed only after unpacking is complete, notify the delivering carrier immediately and request an inspection of the damaged merchandise before proceeding.

Locate the Inspection List and retain this with the waybill. Identify all parts with the Parts List (on the reverse) as they are unpacked and compare with the Inspection List. Once all parts have been identified, inspected for freight damage, and counted, proceed to assembly.

ASSEMBLY INSTRUCTIONS

Before attempting assembly, refer to the Parts Diagram on the reverse side. Begin by locating Item 13, trough base. Insert Item 11, the feed axle into the recess at the center of the trough. Drill four (4) holes through the fiberglass trough base, using the feed axle as a guide and a 3/16-in. drill bit. (NOTE: Masonry type drill bits are preferred for fiberglass because high speed steel bits rapidly become dull).

Fasten the plate of the feed axle to the trough with the four (4) flat-head bolts and flange nuts provided. Using Locktite on axle bolts and nuts is recommended. Next locate the feed wheel washer, Item 10 and the feed wheel, Item 9, on the feed axle. The feed wheel should turn freely on the feed axle. If it does not, check for paint residues and remove if necessary.

Next, place the cage, Item 7, on the trough base. Make certain the cage is forced as far over the trough lip as possible. Now drill one (1) 5/16-in. hole, using the cage as a guide. Insert one of the cage bolts in the hole with the head to the OUTSIDE of the feed trough. Install a flanged cage nut and hand tighten. Repeat this procedure for the remaining holes, checking each time that the cage is down as far as possible. Now tighten the bolts by holding the nuts and turning the heads. **DO NOT OVERTIGHTEN THE BOLTS ON THE FIBERGLASS;** tighten only until snug. Overtightening can damage the fiberglass.

After the cage is installed, attach the cage tightener bolt and nut, but do not tighten. Drop the hopper bottom, Item 4, into place. Drop the feed sweep, Item 2, on the feed wheel. Slide the sweep over the feed wheel until it touches the hopper bottom. If it does not touch the bottom it is upside down; remove it and turn it over. Then raise the sweep until it just clears the hopper and tighten the set screw. Rotate the wheel to be certain the sweep does not rub; adjust as necessary.

Next slide the hopper top, Item 1, inside the hopper bottom as far as it will go. The flat area above the step in the hopper top should be completely inside the hopper bottom. Make sure the top is on straight and down as far as possible. Now tighten the cage tightener bolt until the hopper no longer will easily rotate within the cage. Lock the jam nut. Drill seven (7) holes through the hopper top and bottom, using the cage as a guide and a 5/16-in. bit. Fasten the hopper with the 5/16-in. bolts provided. Tighten by holding the nuts and turning the heads as explained previously. **DO NOT OVERTIGHTEN.**

Your Big Wheel Feeder is equipped with a feed gauge for ease of setting feed flow. Assemble Item 15 through Item 23b as follows. Locate Item 17b. and insert into one end of Item 17c. Place the jam nut, Item 17e. on the bolt and thread to expose approx. 3/4" of thread.

Place the cone support, Item 20 under the fiberglass cone, Item 18. Place the washer, Item 19 on top of the fiberglass cone. Insert the bolt previously installed in the cone strap, Item 17d. through the washer, fiberglass cone, and into the cone support. Thread the bolt into the cone support approximately 4 complete turns. Note: If the bolt is inserted into the cone support further than recommended, the cone assembly may be limited on adjustment. Tighten the jam nut, Item 17e., snugly against the washer. Be careful not to over tighten.

Insert the Feed Gauge Assembly bolt, Item 17b., into the opposite end of the cone strap, Item 17c. Be sure the threaded portion of the bolt extends away from the center of the cone strap. Place one of 3/8 nut, Item 17a., on the bolt thread followed by the feed readout plate, Item 17h. Ensure that the long leg of the feed readout plate is extended away from the cone strap, Item 17c. Place another 3/8 nut, Item 17a., on the bolt and hand tighten against the feed readout plate.

Next install the crossbar, Item 17, on the top rim of the feeder hopper. If fenceline adapters are used, align the crossbar with the divider rods in the trough divider, Item 7. Using the crossbar ends as a guide, drill four (4) 3/16" diameter holes in the top rim. Secure the crossbar using the four (4) No.10 bolts and nuts provided.

Place the cone assembly into the feeder hopper, aligning the cone support on the feed wheel axle. Insert the long bolt through the center hole located in the crossbar, Item 17. Locate the handle nut, Item 15, and thread onto the long bolt. Continue to tighten the handle nut until the cone assembly begins to move upward. Note: The cone assembly should be slightly above the feed sweep, without resting on it. Adjust the feed readout plate using the two (2) 3/8 nuts installed on the long bolt. Align the numeral 1 printed on the feed readout label with in the top of the crossbar. Tighten the 3/8" nut against the feed readout plate and lock them into place. This setting will be the lowest recommended setting.

Place the bump bar agitators, Item 23, into the holes in the crossbar directly above the feed sweep, Item 2. The agitators should hang in the feeder hopper with the threaded portion of the agitator extending out the top of the cross bar. Install the Nylon lock nut and washer, Item 23a. and 23b., on the agitator bar and adjust according to the enclosed Bump Bar Installation Instructions, RLX-0518. The assembly of the Osborne Big Wheel feeder is now complete. **Finally, check the tightness of all bolts 24 hours after assembly to compensate for any relaxation in the fiberglass parts.**

Your RN1 Big Wheel finish feeder is now ready to be anchored to the pen floor, either in the middle or in the penline. Attach three anchor brackets, Item 21, to the cage rim, then to concrete floors using lead sleeves or to slotted or mesh floors using stainless steel T-bolts, Item 22. Order T-bolts and brackets separately. Special penline adapters are also available.

CARE AND MAINTENANCE

To train pigs to use the feeder, fill the hopper with feed, spin the feed wheel until feed appears in the trough, and then manually overfill the trough with a feed scoop the first time. As the first troughful is eaten, pigs learn through play how the feed wheel works. A creep feeding program will also help. If no creep feeding precedes weaning, it may be necessary to repeat manual filling, before self-feeding begins.

Your RN1 Big Wheel feeds up to 50 animals from 25 lbs. to 85 lbs. Your Big Wheel hog feeder has been designed for maximum strength and durability. It does not require any special care. Because eventual deterioration or breakage is inevitable, the Big Wheel is designed so that repair is relatively quick and simple. Repair parts can be ordered through your nearest Osborne Dealer.

Big Wheel®

Parts Diagram and Listing

Model RN1- Round Nursery Feeder - 4.5 Bu.

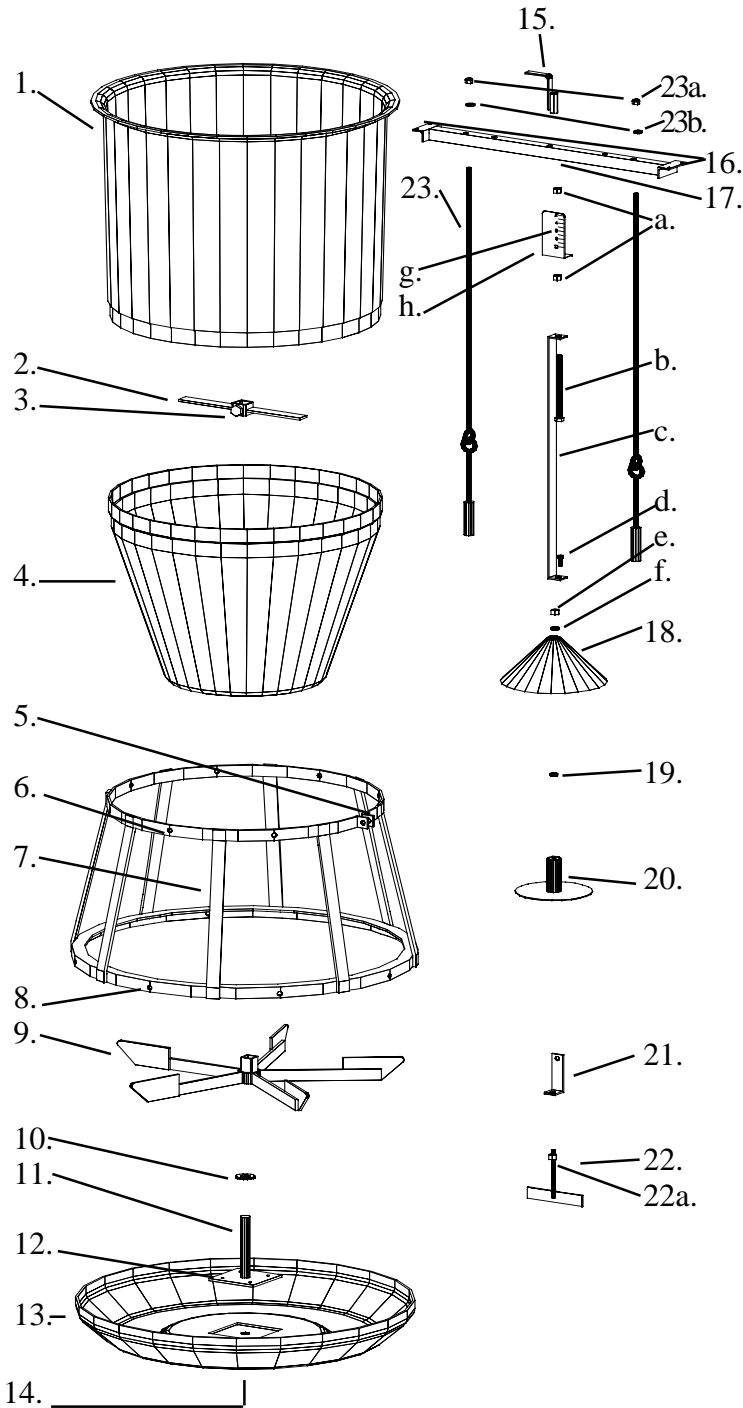

(T-bolt and Anchor Bracket must be ordered separately.)

Item No.	Part No.	Part Name
1.	KF-N10002	Hopper top
2.	KF-N10007	Feed Sweep
3.	RFB-1100	Set Screw
4.	KF-N10001	Hopper Bottom
5.	RFB-2150	Tightener Bolt
	RFN-2100	Tightener Nut
	RFN-2200	Tightener Jam Nut
6.	RFB-2050	Divider Bolts (7 ea.)
	RFN-2300	Divider Nuts (7 ea.)
7.	KF-N10005	Trough Divider Cage
8.	RFB-2050	Divider Bolts (8 ea.)
	RFN-2300	Divider Nuts (8 ea.)
9.	KF-N10006	Feed Wheel
10.	RFW-7001	Feed Wheel Washer
11.	KF-N10008	Axle
12.	RFB-0821	Axle Bolts (4 ea.)
13.	KF-N10003	Trough
14.	RFN-0851	Axle Flange Nuts (4 ea.)
15.	KF-F10017	Handle Nut
16.	RFB-0810	Crossbar Bolts (4 ea.)
	RFN-0811	Crossbar Nuts (4 ea.)
17.	KF-N10011	Crossbar
a.	RFN-3100	Full Hex Nuts (2 ea.)
b.	RFB-3910	Feed Gauge Assembly Bolt
c.	KF-N10013	Cone Strap
d.	RFB-3200	Bolt
e.	RFN-3500	Jam Hex Nut 3/8" (1 ea.)
f.	RFW-3100	Flat Washer
g.	RLX-0344	Label, Big Wheel Adjustment Plate
h.	KF-F10016	Feed Gauge Adjustment Plate
18.	KF-N10004	Cone
19.	RFW-2000	Cone Support Washer
20.	KF-N10009	Cone Support
21.	FF-00RN1E	Anchor Bracket
22.	FF-000TB1	T-Bolt S.S.
a.	RFN-2401	T-Bolt Lock Nut
23.	FF-00RN1B	Bump Bar Agitator
a.	RFN-1401	Bump Bar Lock Nut (2 ea.)
b.	RFW-2000	Bump Bar Washer (2 ea.)

